

# PV1 Series

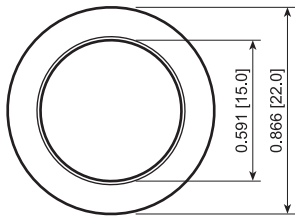

## Suggested Panel Cutout

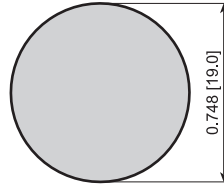

Maximum Panel Thickness: 0.315 [8.0]

## FEATURES:

- Vandal and Water Resistant
- Long Life Expectancy
- Custom Laser Engraved Markings

## SPECIFICATIONS:

**RATING:** 2A 48VDC  
**TEMPERATURE:** -20°C to 70°C  
**ELECTRICAL LIFE:** 200,000 Cycles  
**CONTACT RESISTANCE:** 50mΩ Max. at 1A 12VDC  
**INSULATION RESISTANCE:** 1,000MΩ Min.  
**DIELECTRIC STRENGTH:** 2,000VAC for 1 Minute  
**INTRUSION PROTECTION:** IP65

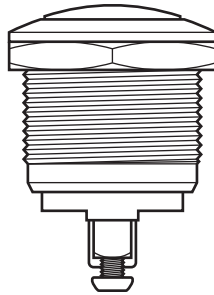
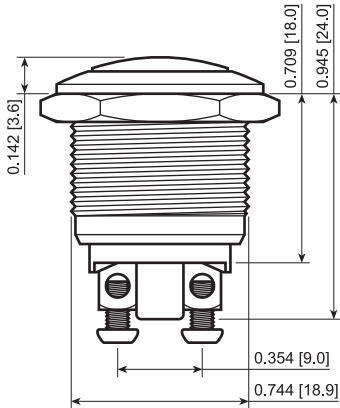

## Actuator Options

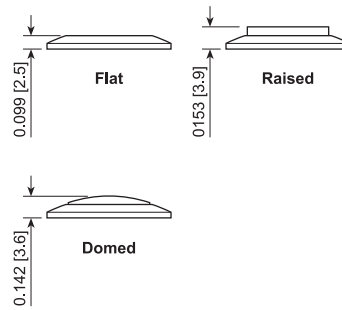

## Terminal Options

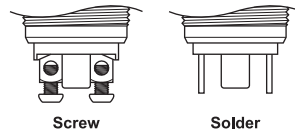

## MATERIALS:

**BUSHING:** Gold Plated Brass  
 Nickel Plated Brass  
 Stainless Steel  
**ACTUATOR:** Gold Plated Brass  
 Nickel Plated Brass  
 Stainless Steel  
**BASE:** Polybutylene Terephthalate, UL94 V-2  
**SEALING:** Silicone  
 Stainless Steel  
**INNER ASSEMBLY:** Polyamide 6/6  
 Brass  
**SPRING:** Steel  
**CONTACT:** Silver Plated Brass  
**TERMINALS:** Silver Plated Brass  
 Steel  
**HARDWARE:** Nickel Plated Brass

ANTI-VANDAL



PV1H640NN



PV1F640SS

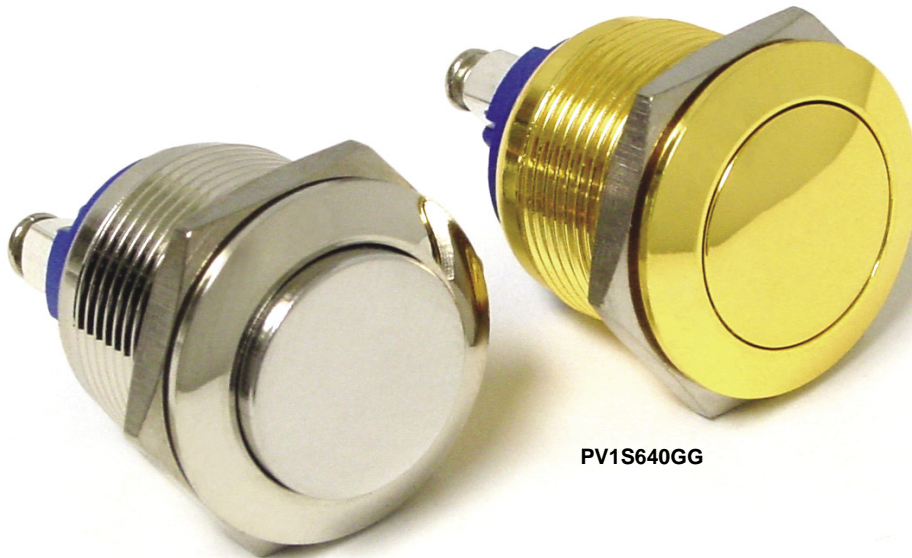

PV1H640SS

PV1S640GG

SPECIFICATIONS SUBJECT TO CHANGE WITHOUT NOTICE

## EXAMPLE PART NUMBERS:

- PV1F640GG 1P Off-(On)  
*Flat Actuator, Gold Plated Finish*
- PV1F640NN 1P Off-(On)  
*Flat Actuator, Nickel Plated Finish*
- PV1F640SS 1P Off-(On)  
*Flat Actuator, Stainless Steel Body*
- PV1H640GG 1P Off-(On)  
*High Actuator, Gold Plated Finish*
- PV1H640NN 1P Off-(On)  
*High Actuator, Nickel Plated Finish*
- PV1H640SS 1P Off-(On)  
*High Actuator, Stainless Steel Body*
- PV1S640GG 1P Off-(On)  
*Domed Actuator, Gold Plated Finish*
- PV1S640NN 1P Off-(On)  
*Domed Actuator, Nickel Plated Finish*
- PV1S640SS 1P Off-(On)  
*Domed Actuator, Stainless Steel Body*

Series	Actuator Options	Terminal	Function	Rating	Body Finish	Actuator Finish	Contact Material	Marking Options
PV1	F - Flat H - High S - Domed	2 - Solder 6 - Screw	1 Pole: 4 - Off-(On)	0 - 2A 48VDC	G - Gold N - Nickel S - Polished Stainless Steel B - Brushed Stainless Steel	G - Gold N - Nickel S - Polished Stainless Steel B - Brushed Stainless Steel	None - Silver G - Gold	None - No Marking M01 - Power Symbol  Custom Markings Available

Notes:  
 Additional material options available upon request. Please ask your salesperson.

